

TYPE 28/15

Material: Stainless Steel A2

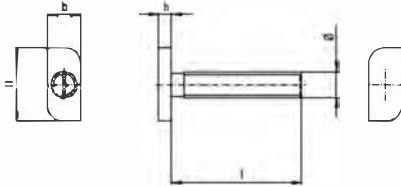

Diameter	Length	Head Length	Head Width	Head Height	Item #
M8	16 mm	22.5-23.0 mm	10 mm	4 mm	909728-16
M8	20 mm	22.5-23.0 mm	10 mm	4 mm	909728-20
M8	25 mm	22.5-23.0 mm	10 mm	4 mm	909728-25
M8	30 mm	22.5-23.0 mm	10 mm	4 mm	909728-30
M8	35 mm	22.5-23.0 mm	10 mm	4 mm	909728-35
M8	40 mm	22.5-23.0 mm	10 mm	4 mm	909728-40
M8	45 mm	22.5-23.0 mm	10 mm	4 mm	909728-45
M8	50 mm	22.5-23.0 mm	10 mm	4 mm	909728-50
M8	53 mm	22.5-23.0 mm	10 mm	4 mm	909728-53
M8	60 mm	22.5-23.0 mm	10 mm	4 mm	909728-60
M8	70 mm	22.5-23.0 mm	10 mm	4 mm	909728-70
M10	20 mm	22.5-23.0 mm	10 mm	4.5 mm	9097210-20
M10	25 mm	22.5-23.0 mm	10 mm	4.5 mm	9097210-25
M10	30 mm	22.5-23.0 mm	10 mm	4.5 mm	9097210-30
M10	35 mm	22.5-23.0 mm	10 mm	4.5 mm	9097210-35
M10	40 mm	22.5-23.0 mm	10 mm	4.5 mm	9097210-40
M10	45 mm	22.5-23.0 mm	10 mm	4.5 mm	9097210-45
M10	50 mm	22.5-23.0 mm	10 mm	4.5 mm	9097210-50
M10	60 mm	22.5-23.0 mm	10 mm	4.5 mm	9097210-60
M10	70 mm	22.5-23.0 mm	10 mm	4.5 mm	9097210-70
M10	80 mm	22.5-23.0 mm	10 mm	4.5 mm	9097210-80
M10	90 mm	22.5-23.0 mm	10 mm	4.5 mm	9097210-90
M10	100 mm	22.5-23.0 mm	10 mm	4.5 mm	9097210-100

For profiles 28/12, 28/15, 28/28, 28/38, 26/26 and 26/18. Packed in quantities of 100.



TYPE 28/15 WITH SQUARE NECK

Material: Stainless Steel A2

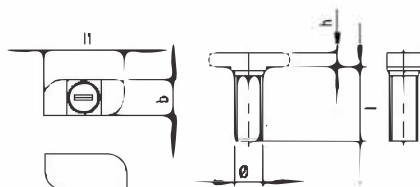

Diameter	Length	Head Length	Head Width	Head Height	Item #
M8	20 mm	22.5-23.0 mm	10 mm	4 mm	9097208-20
M8	40 mm	22.5-23.0 mm	10 mm	4 mm	9097208-40
M8	45 mm	22.5-23.0 mm	10 mm	4 mm	9097208-45

For profiles 28/12, 28/15, 28/28, 28/38, 26/26 and 26/18. Packed in quantities of 100.

TYPE 41/41 WITH PARTIAL SERRATION

Material: Stainless Steel A2

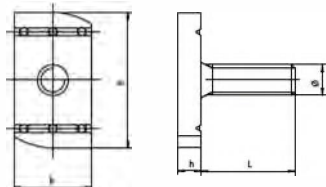

Diameter	Length	Head Length	Head Width	Head Height	Item #
M8	30 mm	34.5 mm	19.5 mm	6 mm	909928-30
M10	30 mm	34.5 mm	19.5 mm	6 mm	9099210-30

For profiles 41/21 and 41/41. Packed in quantities of 100.